



masskot

SUPER PRECISION LOADCELL

BCA L- LOADCELL

SINGLE POINT

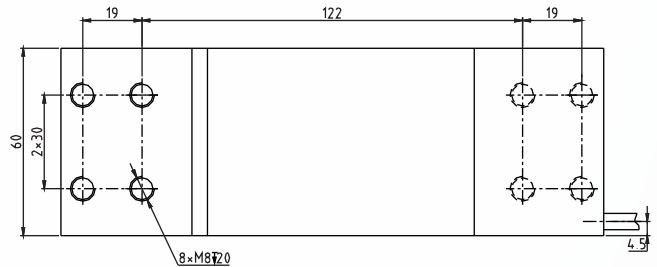
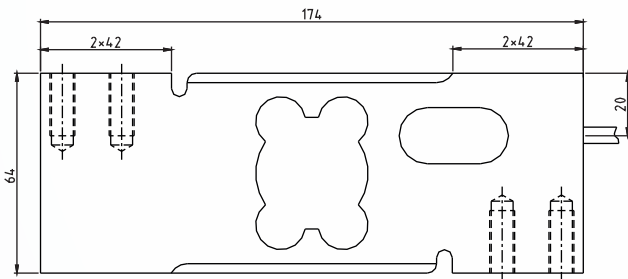

Platform scale, all kinds of compression testing devices

TECHNICAL PARAMETER

OAP version 4Wires:Exc+(Blue);Exc-(Black);Sig+(White);Sig-(Red)

| | | | |
|------------------------|---|----------------------------------|-----------------|
| Rated capacities(Emax) | 50,60,75,100,150,200,250,300,350,500,600,635,750,800kg;1t | Temperature range, compensated | -10°C~+40°C |
| Sensitivity | 2.0 ± 0.2mV/V | Temperature range, operating | -20°C~+50°C |
| Accuracy class | OIML C3 | Maximum safe overload | 150%Emax |
| Creep error (30min) | ± 166ppm | Ultimate overload | 300%Emax |
| Zero balance | ± 3%Emax | Excitation, recommended | 10V DC |
| TC ZERO | ± 17.5ppm/°C | Excitation, maximum | 15V DC |
| TC SPAN | +20°C~+40°C, ± 17.5ppm/°C | Protection class | IP65 |
| | -10°C~+20°C, ± 11.67ppm/°C | Construction | Aluminium |
| Input resistance | 404 ± 15Ω | Cable | Length:1.8m |
| Output resistance | 350 ± 3Ω | | Diameter: φ 5mm |
| Insulation resistance | ≥ 2000 MΩ (50V DC) | Installation torque, recommended | 25N · m |
| Max platform size | 600 × 600mm | | |

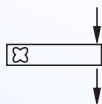

MBN047